

PERMIT  
CITY OF NAPOLEON, OHIO - BUILDING DEPARTMENT  
255 West Riverview Avenue, Napoleon, Ohio 43545 - (419) 592-4010

Permit No. 3162 Issued 4-4-94  
 Job Location 925 Chesterfield  
 Lot 27 Twin Oaks 1st  
 Issued by Brent N. Damman  
 Owner Peter C. Beck 592-2701  
 Address 827 Norton  
 Agent Rupp/Rosebrock 533-7999  
 Address 4-050 U.S. Rt. 24, Liberty Center  
 Use Type - Residential X  
 Other - Describe \_\_\_\_\_  
 No. Dwelling Units \_\_\_\_\_  
 New X Replacement \_\_\_\_\_  
 Add'n. Alter Remodel \_\_\_\_\_  
 Mixed Occupancy \_\_\_\_\_  
 Change of Occupancy \_\_\_\_\_  
 Estimated Cost \$ 400,000.00

FEES	BASE	PLUS	TOTAL
<input checked="" type="checkbox"/> Building	\$ 9.00	\$ 472.80	\$ 481.80
<input checked="" type="checkbox"/> Electrical	\$ 15.00	\$ 135.00	\$ 135.00
<input checked="" type="checkbox"/> Plumbing	\$ 18.00	\$ 81.00	\$ 99.00
<input checked="" type="checkbox"/> Mechanical	\$ 36.00	\$ 20.00	\$ 46.00
<input type="checkbox"/> Demolition	\$	\$	\$
<input type="checkbox"/> Zoning	\$	\$	\$
<input type="checkbox"/> Sign	\$	\$	\$
<input checked="" type="checkbox"/> Water Tap	\$ 650.00	\$	\$ 650.00
<input checked="" type="checkbox"/> Sew. Insp.	\$ 60.00	\$ 248.39	\$ 308.39
<input checked="" type="checkbox"/> Sewer Tap	\$ 5.00	\$	\$ 5.00
<input checked="" type="checkbox"/> Temp. Water	\$ 10.00	\$	\$ 10.00
<input type="checkbox"/> Temp. Elec.	\$	\$	\$
TOTAL FEES.....			\$ 1,735.19
LESS FEES PAID.....			\$
BALANCE DUE.....			\$ 1,735.19

**ZONING INFORMATION**

district	lot dimensions	area	front yd	side yd	rear yd
S	130 x 130	20,556	40'	15'	20'
max hgt	no pkg spaces	no ldg spaces	max cover	petition or appeal req'd	date appr
30'	2 per		30%		

**WORK INFORMATION**

Size: Length \_\_\_\_\_ Width \_\_\_\_\_ Stories \_\_\_\_\_ Ground Floor Area 3063  
 Height \_\_\_\_\_ Building Volume (for Demo. Permit) \_\_\_\_\_  
 Electrical: \_\_\_\_\_ **PAID**  
 Plumbing: \_\_\_\_\_ MAY 02 1994  
 Mechanical: \_\_\_\_\_ CITY OF NAPOLEON

Additional Information: New dwelling.

Date 4-8-94 Applicant Signature [Signature]

# INSPECTION RECORD

	UNDERGROUND			ROUGH-IN					FINAL			
	Type	Date	By	Type	Date	By	Type	Date	By	Type	Date	By
<b>PLUMBING</b>	Building Drains			Drainage, Waste & Vent Piping	8/19/94	RCJ	Indirect Waste			Drainage, Waste & Vent Piping	8/19/94	RCJ
	Water Piping			Garage Drains	5/17	BD				Backflow Prevention		
	Building Sewer			Water Piping			Condensate Lines			Water Heater		
	Sewer Connection									FINAL APPROVAL		
<b>MECHANICAL</b>	Refrigerant Piping			Refrigerant Piping			Chimney(s)	8/22/94	RCJ	Grease Exhaust System		
				Duct Furnace(s)	8/22/94	RCJ	Fire Dampers			Air Cond. Unit(s)		
	Ducts/Plenums			Ducts/Plenums	8/22/94	RCJ	<input type="checkbox"/> Radiant Htr(s) <input type="checkbox"/> Unit Htr(s)			Refrigeration Equipment		
				Duct Insulation	8/22/94	RCJ	Pool Heater			Furnace(s)	7/16	BD
				Combustion Products Vents	8/22/94	RCJ	Ventilation <input checked="" type="checkbox"/> Supply <input type="checkbox"/> Exhst.	7/16	BR	FINAL APPROVAL		
<b>ELECTRICAL</b>	Conduits & or Cable			Conduits/Cable	8/24/94	RCJ	<input type="checkbox"/> Range <input type="checkbox"/> Dryer	8/24/94		Temp Service Temp Lighting		
	Grounding & or Bonding			Rough Wiring	8/24/94	RCJ	<input type="checkbox"/> Generator(s) <input type="checkbox"/> Motors			Fixtures Lampholders		
	Floor Ducts Raceways			Service Panel Switchboard			<input type="checkbox"/> Water Htr <input type="checkbox"/> Welder			Signs		
	Service Conduit			Busways Ducts			<input type="checkbox"/> Heaters <input type="checkbox"/> Heat Cable			Electric Mtr. Clearance		
	Temporary Power Pole			Subpanels			<input type="checkbox"/> Duct Htr(s) <input type="checkbox"/> Furnace(s)			FINAL APPROVAL		
<b>BUILDING</b>	Location, Set-backs, Esmt(s)	4/11	BD	Exterior Wall Construction	6/17	BD	Roof Covering Roof Drainage	7/16	BD	Smoke Detector		
	Excavation						Exterior Lath	7/16	BD	Demolition (sewer cap)		
	Footings & Reinforcing	4/11	BD				<input checked="" type="checkbox"/> Interior Lath <input type="checkbox"/> Wallboard	7/16	BD			
	Floor Slab			Interior Wall Construction	6/12	BD	Fire Wall(s)			Building or Structure		
	Foundation Walls	4/11	BD	Columns & Supports	6/17	BD	Fireplace Chimney	8/22/94	RCJ			
	Sub-soil Drain			Crawl Space <input type="checkbox"/> Vent <input type="checkbox"/> Access			Attic <input type="checkbox"/> Vent <input type="checkbox"/> Access	7/22/94	RCJ			
	Piles			Floor System(s)	6/17	BD				FINAL APPROVAL BLDG. DEPT.	2/12	BD
				Roof System	6/17	BD	Special Insp Reports Rec'd			Certificate of Occupancy Issued	7/12	BD
<b>ADDITIONAL</b>	<b>INSPECTIONS, CORRECTIONS, ETC.</b>						<b>INSPECTIONS, CORRECTIONS, ETC.</b>					
	Suggested outside pump pit to enter brick + John Rose block											
	Inspected Framing & Duct Work						6/13/94 RCJ					

**APPLICATION FOR**

Residential, Building, Electrical, Plumbing, Mechanical, and Demolition Permit  
 FROM - The City of Napoleon, Ohio, Building Department  
 255 West Riverview Avenue; P.O. Box 151; Napoleon, Ohio 43545 - Telephone (419) 592-4010

ENTRY NO. \_\_\_\_\_

PERMIT NO. 3162 ISSUED 4-4-94

JOB LOCATION 925 Chesterfield

LOT 27 Twin Oaks 1st  
 (Subdivision or Legal Description)

ISSUED BY BND  
 (Building Official)

OWNER Peter C. Beck PHONE 592-2701

ADDRESS 827 Norton

AGENT Rupp/Rosebrock PHONE 533-7999

ADDRESS 4-050 U.S. Rt. 24 Liberty Center

USE:  Residential  Commercial  Industrial  
 Other \_\_\_\_\_

WORK:  New  Addition  Replacement  Remodel

ESTIMATED COST = \$ 400,000.00

	<u>Base</u>	<u>Plus</u>	<u>Total</u>
<input checked="" type="checkbox"/> Building	\$ <u>9.00</u>	\$ <u>472.88</u>	\$ <u>481.80</u>
<input checked="" type="checkbox"/> Electrical	\$ <u>15.00</u>	\$ <u>135.00</u>	\$ <u>135.00</u>
<input checked="" type="checkbox"/> Plumbing	\$ <u>18.00</u>	\$ <u>81.00</u>	\$ <u>99.00</u>
<input checked="" type="checkbox"/> Mechanical	\$ <u>36.00</u>	\$ <u>20.00</u>	\$ <u>46.00</u>
<input type="checkbox"/> Demolition	\$ _____	\$ _____	\$ _____
<input type="checkbox"/> Zoning	\$ _____	\$ _____	\$ _____
<input type="checkbox"/> Sign	\$ _____	\$ _____	\$ _____
<input checked="" type="checkbox"/> Water Tap	\$ <u>650.00</u>	\$ _____	\$ <u>650.00</u>
<input checked="" type="checkbox"/> Sewer Tap	\$ <u>60.00</u>	\$ <u>248.39</u>	\$ <u>308.39</u>
<input checked="" type="checkbox"/> Temp Water	\$ <u>5.00</u>	\$ _____	\$ <u>5.00</u>
<input checked="" type="checkbox"/> Temp Elec.	\$ <u>10.00</u>	\$ _____	\$ <u>10.00</u>

Additional Plan Review: Structure \_\_\_\_\_ Hours \_\_\_\_\_  
 Electric \_\_\_\_\_ Hours \_\_\_\_\_

TOTAL FEES . . . . .	\$ <u>1735.19</u>
Less Fees Paid . . . . .	\$ _____
BALANCE DUE . . . . .	\$ <u>1735.19</u>

ZONING INFORMATION

District	Lot Dimensions	Area	Front Yard	Side Yard	Rear Yard
S	130 X 130	20,556	40	15'	20'

Max Height	No. Pkg. Spaces	No. Ldg. Spaces	Max Cover	Petition or Appeal Required-Date
30'	2 per		30%	

WORK INFORMATION

Building: Ground Floor Area 3063 sq. ft. Basement Floor Area 2508 sq. ft.  
 Garage Floor Area 943 sq. ft. 2nd Floor Area 771 sq. ft. Other \_\_\_\_\_ sq. ft.  
 Size: Width 56' Length 91' Stories 2 Height 30'  
 Building Volume (for Demolition Permit) \_\_\_\_\_ cubic feet

Description of Work: New dwelling.

ELECTRICAL:  Contractor \_\_\_\_\_ Phone \_\_\_\_\_

Address \_\_\_\_\_ ESTIMATED COST = \$ \_\_\_\_\_

Type of Work:  New ( ) Service Change ( ) Rewiring ( ) Add'l Wiring TEMPORARY ELEC. REQUIRED -  Yes ( ) No

Size of Service 200 Underground \_\_\_\_\_ Overhead \_\_\_\_\_ Number of New Circuits 45

Description of Work: \_\_\_\_\_

PLUMBING:  Contractor \_\_\_\_\_ Phone \_\_\_\_\_

Address \_\_\_\_\_ ESTIMATED COST = \$ \_\_\_\_\_

WATER TAP REQUIRED -  Yes ( ) No Size 1" Type of Pipe CTS Water Dist. Pipe \_\_\_\_\_

SANITARY SEWER TAP REQUIRED -  Yes ( ) No Size 4" Type of Pipe SDR35 Dr. Waste Vt. Pipe \_\_\_\_\_

STREET SEWER TAP REQUIRED -  Yes ( ) No Type of Pipe 4" STREET TO BE OPENED - ( ) Yes  No

Main Building Drain Size = 4" Main Vent Pipe Size = 4"

LIST NUMBER OF PLUMBING FIXTURES BELOW:

Water Closets = 5 Bathtubs = 3 Showers = 2 Lavatories = 7 Kitchen Sinks = 1 Disposal = 1

Clothes Washer = 1 Floor Drains = 185 Dishwasher = 1 Other h.t.-1 Total = 27

Description of Work: \_\_\_\_\_

MECHANICAL: Contractor \_\_\_\_\_ Phone \_\_\_\_\_

Address \_\_\_\_\_ ESTIMATED COST = \$ \_\_\_\_\_

HEATING SYSTEM -  Forced Air ( ) Gravity ( ) Hot Water ( ) Steam ( ) Unit Heaters ( ) Radiant ( ) Baseboard

TYPE OF FUEL - ( ) Electric ( ) Natural Gas ( ) Propane ( ) Wood ( ) Coal ( ) Solar ( ) Geothermal Other \_\_\_\_\_

NUMBER OF HEAT ZONES = 2 HOT WATER - ( ) One (1) Pipe ( ) Two (2) Pipes ( ) Series Loop

ELECTRIC HEAT - Number of Circuits \_\_\_\_\_ Number of Furnaces 2 Number of Hot Air Runs 28

Number of Hot Water Radiators \_\_\_\_\_ Total Heat Loss 125,000 Rated Capacity of Furnace/Boiler \_\_\_\_\_

LOCATION OF HEATING UNITS - ( ) Crawl Space  Floor Level ( ) Attic ( ) Suspended ( ) Roof ( ) Outside

Description of Work: \_\_\_\_\_

DRAWINGS REQUIRED: All applications must be accompanied by two (2) complete sets of Drawings including Site Plans, Foundation Plans, Floor Plans, Structural Framing Plans, Exterior Elevations, Section and Details, Stair Details, Electrical Layout, Plumbing Isometric, Heating Layout, etc. All Plans shall be drawn to scale, show all existing structure on the Site Plans, and show electric panel and furnace locations.

READ AND SIGN BELOW: The undersigned hereby makes application for a Permit for all work described herein and agrees to complete the work in strict accordance with all applicable provisions of the current edition of the C.A.B.O. Building Code, the Napoleon Building and Zoning Codes, the Napoleon Engineering Department Rules and Regulations, Standard Specifications and other pertinent sections of the Napoleon Code of Ordinances.

Signature of Applicant \_\_\_\_\_ Date \_\_\_\_\_

WATER TAPPING PERMIT

issued by

The Napoleon Water Distribution Department

255 West Riverview Ave. Napoleon, Ohio 43545 Ph. 592-4010

Permit No. W-0468 Issued \_\_\_\_\_ Received of \_\_\_\_\_ (\$ \_\_\_\_\_).00

(Charge for tapping permit to supply water service to) Lot No. \_\_\_\_\_ Sub Div. \_\_\_\_\_

Street No. \_\_\_\_\_ Tap Size \_\_\_\_\_ " Cost \$ \_\_\_\_\_ .00 Plumber \_\_\_\_\_

Date completed \_\_\_\_\_ Approved by \_\_\_\_\_  
water distribution dept. \_\_\_\_\_ finance director \_\_\_\_\_

Name Peter Beck Size of tap 1" Date 7-15-94 Street and No. 925 Chesterfield

Old Tap No. — New Tap No. 94115 Size and Kind of Main 8" C-900

Location of Main 4' North of North CURB Depth of Main 5'

Distance from Hydrant/Valve 189' West of Hyd #404 Distance to Curb Stop from Corp. 14'

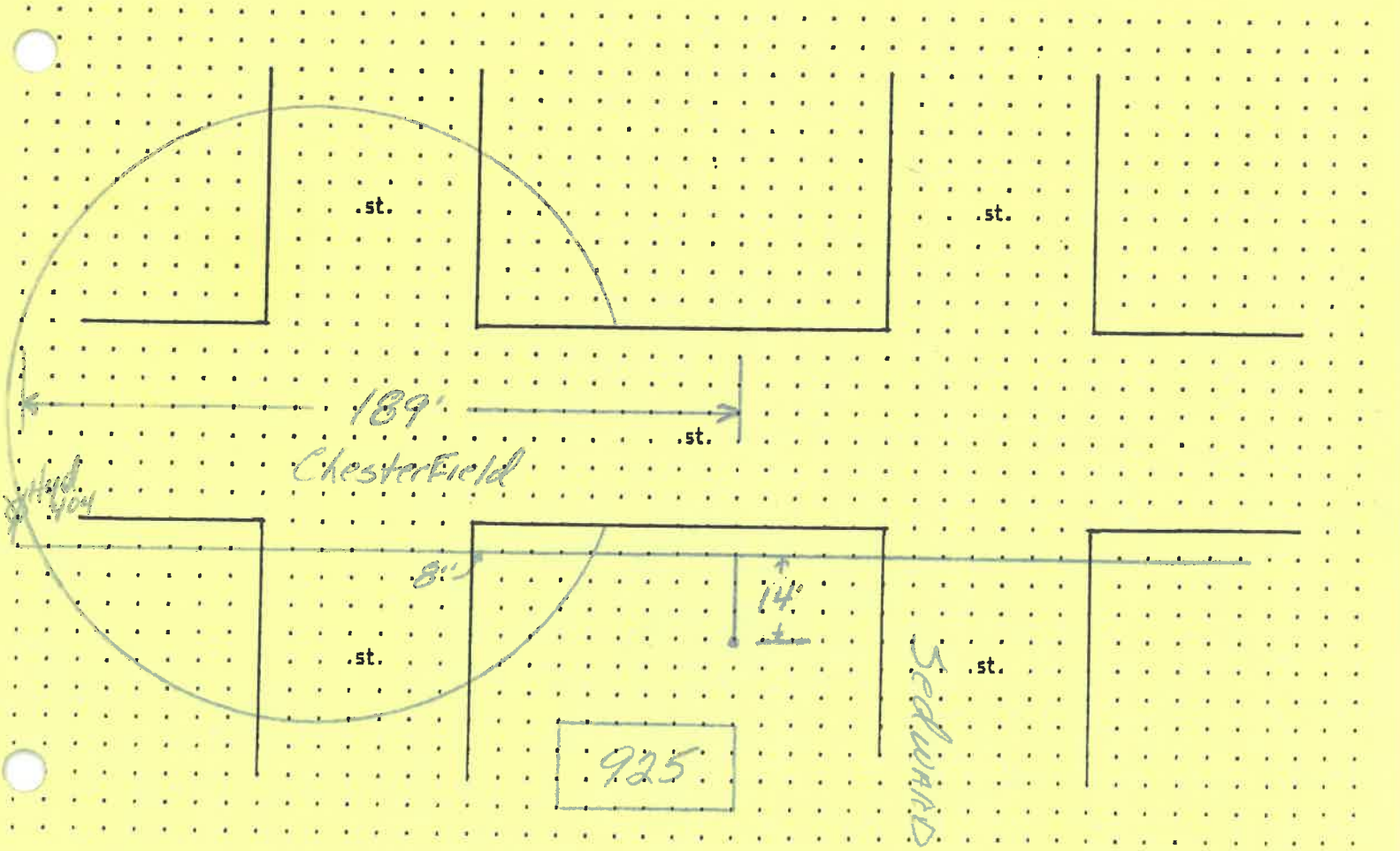



**CITY OF NAPOLEON, OHIO  
STORMWATER ABATEMENT CREDIT APPLICATION**

SERVICE ADDRESS: <u>925 Chesterfield Dr</u> STREET NUMBER                      STREET NAME	ACCOUNT NUMBER: <u>31 01350 1</u>
--	--------------------------------------

SERVICE CLASS:  RESIDENTIAL  COMMERCIAL  INDUSTRIAL                      DATE 1/24/07

ARE YOU THE OWNER:  YES  NO IF NO, COMPLETE PROPERTY OWNER & TENANT INFORMATION BELOW  
IF YES, COMPLETE PROPERTY OWNER INFORMATION BELOW

Tenant	Property Owner
NAME: (LAST, FIRST, MIDDLE INITIAL)	NAME: (LAST, FIRST, MIDDLE INITIAL) <u>Bock Peter C.</u>
ADDRESS: (IF DIFFERENT FROM SERVICE ADDRESS)	ADDRESS: <u>925 Chesterfield</u>
CITY, STATE, ZIP:	CITY, STATE, ZIP: <u>Napoleon, Ohio 43545</u>
HOME PHONE:	HOME PHONE: <u>419 592 2701</u>
WORK PHONE:	WORK PHONE: <u>419 592 0050</u>

ARE YOU APPLYING FOR A COMMERCIAL/ INDUSTRIAL CREDIT (RETENTION & DETENTION) OR ARE YOU CHALLENGING THE E.R.U. CALCULATION FOR THIS ACCOUNT?  YES  NO (IF YES, PLEASE COMPLETE THIS BLOCK)

Total Area of Property/Lot: \_\_\_\_\_ s.f.

Impervious Area: \_\_\_\_\_ s.f.

(ATTACH DRAINAGE & DETENTION CALCULATIONS)

ARE YOU APPLYING FOR RESIDENTIAL MULTIPLE LEVEL UNIT CREDIT?  YES  NO ( IF YES, PLEASE COMPLETE THIS BLOCK)

MULTI-LEVEL BUILDING\*  YES  NO  
BUILDING USE:  RESIDENTIAL  COMMERCIAL

\* Multi-level residential units where there are separate residents on multiple levels are eligible for up to 50% credit.  
\* Multi-level single family residents are **NOT** eligible.

If applying for a multiple electric meter credit, please provide details in the "Additional Information" section below.

Additional Information: Electric meter for a Bond - 915 CHESTERFIELD

C.C.E.L.  
01-23-07

Signature [Signature] APPLICANT                      Date 1/24/07

**FOR CITY USE ONLY**

E.R.U. 1.0  
 Credit\* 100 %  
 E.R.U. Credit: 1.0 (If zero, see explanation below.)  
 Net Billable E.R.U. 0

APPROVED                      EFFECTIVE DATE: \_\_\_\_\_ / \_\_\_\_\_ /20\_\_\_\_  
 DENIED (EXPLANATION ATTACHED IF APPLICABLE)

[Signature]  
CITY ENGINEER                      Date 01/23/07

\*\*RETURN COMPLETED APPLICATION TO ENGINEERING DEPARTMENT\*\*

